

CERTIFICATE OF LOCATION OF GOVERNMENT CORNER

NORTH QUARTER Corner of Section 9, Township 105, Range 43, 5TH P.M.
 STATE OF MINNESOTA, County of MURRAY

At the corner location shown on the sketch:

- On 5/15/14 found a concrete block
DATE
- left monument as found, lowered monument, removed monument (explain)
- On 5/15/14 placed a 1" pipe w/seal #43844
DATE

SKETCH OF REFERENCE TIES

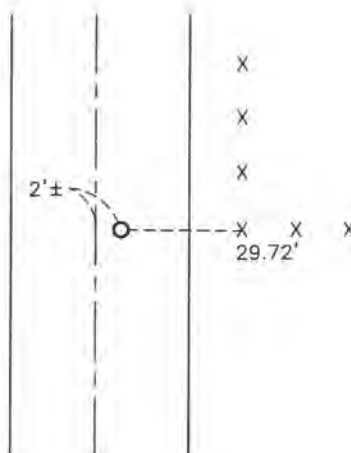

Minnesota State Plane Coordinate
 System Murray County Datum
 NAD83 (1996)

N: 126843.791
 E: 434799.336

Nail and survey marker in corner fence post East 29.72'

Statement of evidence relative to this corner location is on back of page.

I hereby certify that this document and the data contained herein was prepared by me or under my direct supervision.

SIGNATURE

1/14/15
DATE

Registration No. 43844

- Land Surveyor, Professional Engineer
- County Surveyor, County Engineer

OFFICE OF THE COUNTY RECORDER
 County of _____

I hereby certify that this document was filed in the Co. Recorders office at _____ .M on the FEB 20 2015 day of _____ A.D. 20 _____

County Recorder Guellyn C. Larson

By _____, Deputy

DOCUMENT NO. _____

Statement of Evidence

In 1866, J.W. Bishop did the original subdivision of the township.

On June 18, 1913, J.W. Woolstencroft distances were recorded across the north line of Section 9-105-43.

On May 15, 2014, Bueltel-Moseng Land Surveying dug with a backhoe and found a concrete block. It is in line with fence to the east and $2' \pm$ east of centerline. We set 1" pipe with seal #43844 over block.